

### Fast pulse pre-amplifier

#### Features

- DC-coupled, 50 ohm impedance.
- Gain +32 dB
- DC to 10 MHz -3dB bandwidth.
- Very compact package.



#### Applications

- Fast scintillator pulse counting readout (matched for  $\text{LaCl}_3$ ,  $\text{LaBr}_3$  and YAP crystals).
- General pulse counting detector readout

#### Options

- CP10-A is matched to fast crystal scintillators
- See CP10-B for plastic scintillators, CDEMs, and APDs

#### Specifications

Input impedance	50 ohms (when powered).
Gain	+32 dB +/- 0.5 dB into 50 ohm load
Bandwidth	DC to 10 MHz (-3 dB) Unity gain at > 100 MHz
Risetime	30 nsec (10% to 90%)
Output impedance	50 ohms
Noise	< 1 mV RMS at output, DC to 100 MHz
Output drive	>= +/- 1.7 V into 50 ohm load >= +/- 3.4 V into high impedance load
Maximum output cable length	Able to drive >= 30 metre RG-174 or RG-316



### Specifications (continued)

#### Frequency response

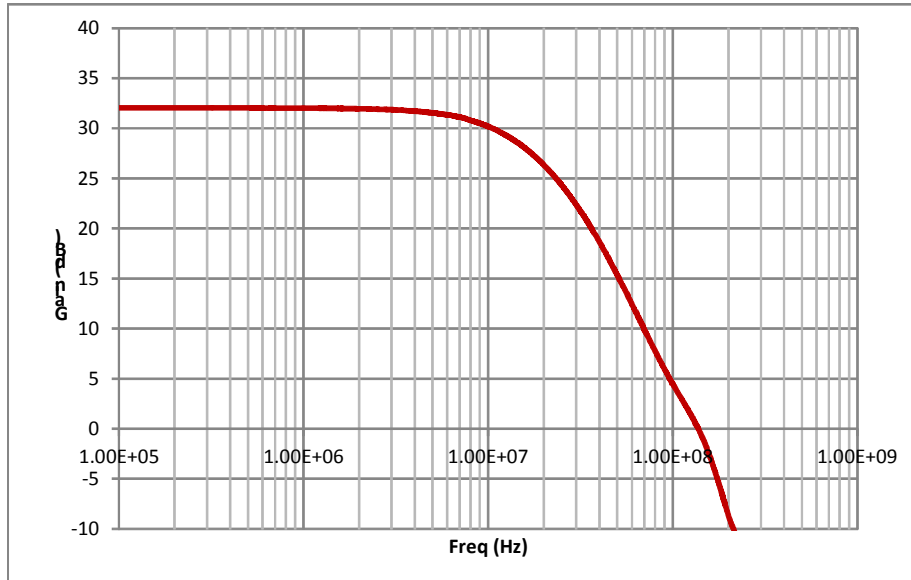

#### Step response

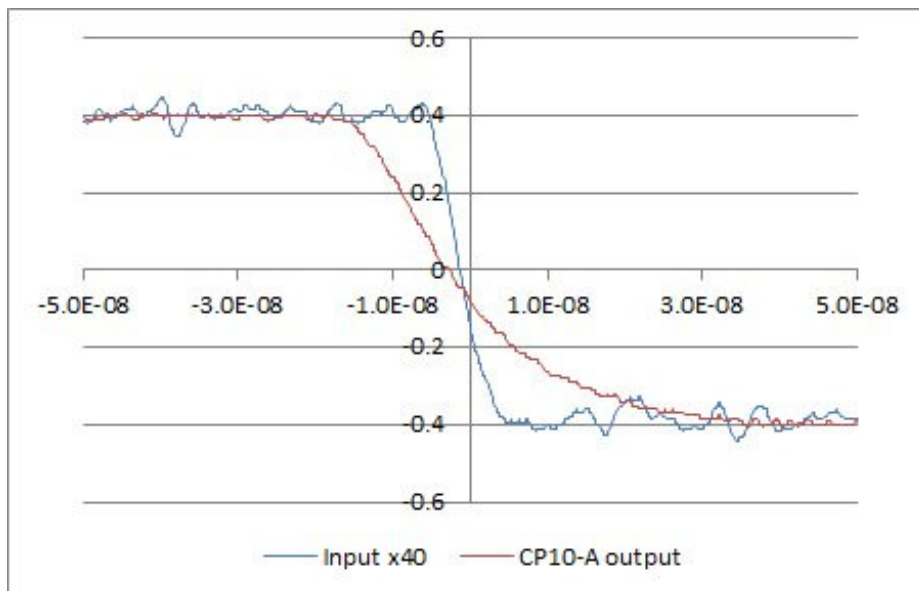

# Datasheet

**CP10-A**

## Specifications (continued)

Power input	+12V (+2/-4 V) DC, 50 mA and -12V (+4/-2 V), 50 mA
Displays	Power on LED
Case	Machined Al alloy case with tapped hole pattern for mounting.
Weight	80 g ( 3 oz)
Operating environment	10 to 35 C (15 to 25 C recommended to reduce drift and offset) , < 70% humidity, non-condensing, vibration < 0.1g all axes (1 to 1000 Hz)
Shipping and storage environment	-10 to 50 C, < 80% humidity, non-condensing, vibration < 1g all axes, 1 to 1000 Hz

## Connectors

Signal input Lemo coaxial size 00

Power Lemo 0B four-pin female  
(mating cable connector FGG.0B.304)

(view on CP10 connector / solder side  
of mating cable connector)

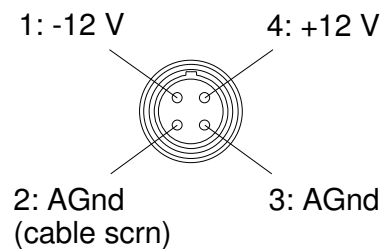

Signal output Lemo coaxial size 00

## Ordering information

CP10-A Pre-amplifier suitable for LaCl<sub>3</sub>, LaBr<sub>3</sub> and YAP scintillator / photomultipliers.

## Related products

CP10-B Fast pre-amplifier (suitable for plastic scintillators, electron multipliers, avalanche photodiodes)

C400 Four channel pulse detector controller (fast window discriminators and scalers, supplies HV bias and pre-amp power).



**Pyramid Technical Consultants**

# Datasheet

**CP10-A**

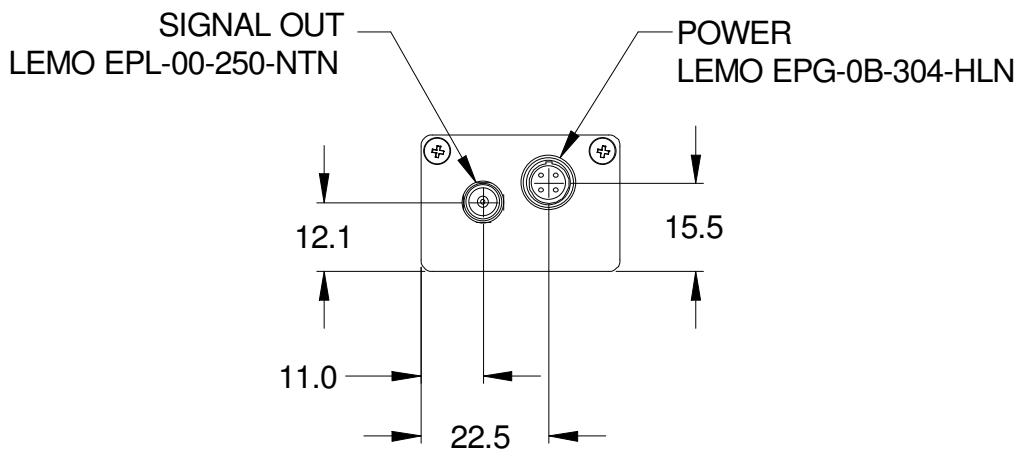
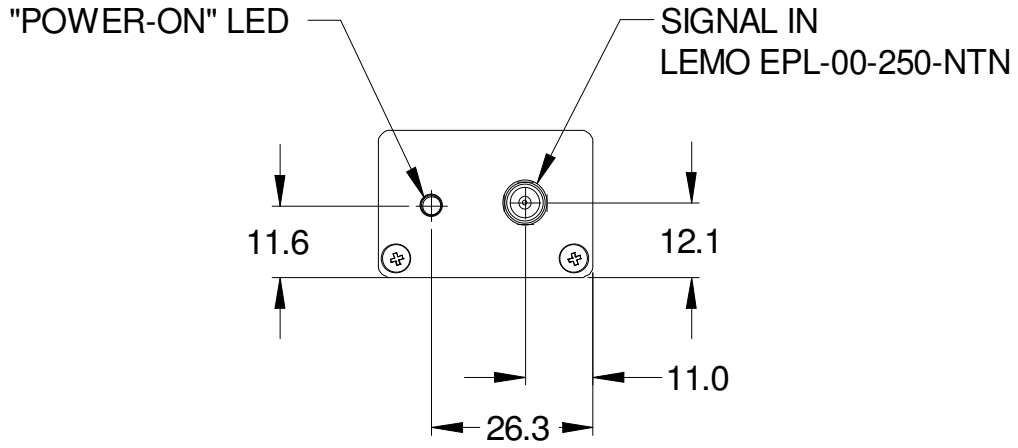

Dims mm

Pyramid Technical Consultants, Inc.,  
1050 Waltham Street Suite 200  
Lexington MA 02421 USA  
Tel: +1 781 402 1700 (USA),  
+44 1273 493590 (UK)

Email: [support@ptcusa.com](mailto:support@ptcusa.com)

[www.ptcusa.com](http://www.ptcusa.com)

The information herein is believed accurate at time of publication, but no specific warranty is given regarding its use. All specifications are subject to change.

All trademarks and names acknowledged.

CP10A\_DS\_110425



**Pyramid Technical Consultants**

**PSI System Controls and Diagnostics**

# Datasheet

**CP10-A**

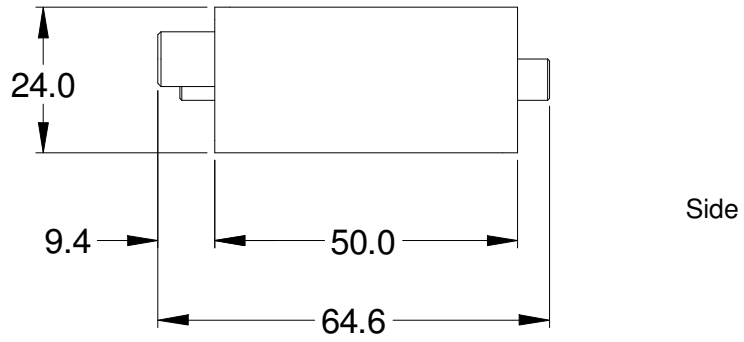

2X  
TAPPED HOLE  
M2.5X0.45 x 5

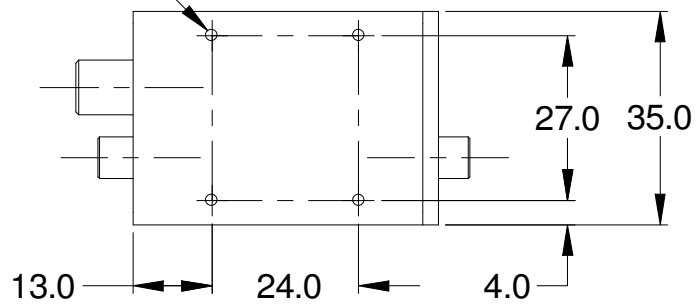

Dims mm



**Pyramid Technical Consultants**